

NOTE:-
1. E-Auction Plots shown

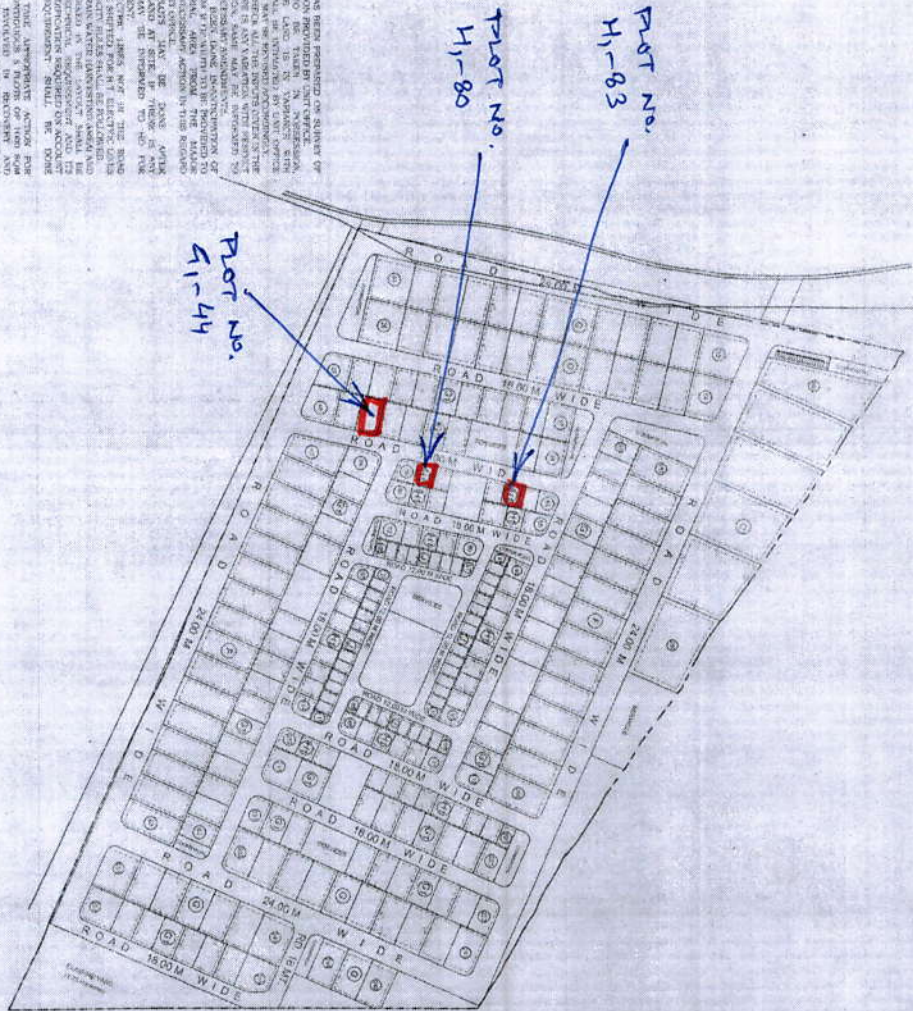

- NOTES:-
1. Final layout plan has been prepared on subject of land and information provided by client office.
 2. Survey data is to be taken in accordance with the Survey Act, 1907 and the Survey Rules, 1956.
 3. The land shown in the plan is the land which is available for the purpose of the scheme.
 4. The plan shows the location of the plots and the roads.
 5. The plan shows the location of the roads and the plots.
 6. The plan shows the location of the roads and the plots.
 7. The plan shows the location of the roads and the plots.
 8. The plan shows the location of the roads and the plots.
 9. The plan shows the location of the roads and the plots.
 10. The plan shows the location of the roads and the plots.
 11. The plan shows the location of the roads and the plots.
 12. The plan shows the location of the roads and the plots.

Handwritten signatures and names:
 Kishor
 Daman
 Kishor
 ASRE
 Arun
 Syam

BADLI

SCHEDULE OF INDUSTRIAL PLOTS

TYPE	S I Z E	AREA	NOS.	SET BACKS	AREA
		(sq. mtr.)		(mtr.)	(sq. mtr.)
C	90.00x110.00	9900	0	0.00	4.50
F	30.00x65.00	2000	30	0.00	3.00
G	30.00x50.00	1500	45	5.00	3.00
G1	25.00x40.00	1000	75	3.00	1.50
H1	20.00x25.00	500	55	3.00	1.50
J	12.50x20.00	250	50	3.00	1.50
TOTAL NOS. OF PLOTS			265		

SCHEDULE OF SHOPS

TYPE	S I Z E	AREA	NOS.	SET BACKS	AREA
		(sq. mtr.)		(mtr.)	(sq. mtr.)
S	3.00x7.50	2250	10		

LAND USE	AREA (IN HECTARE)	%AGE
TOTAL AREA UNDER SCHEME (AS PER REVENUE RECORD)	47.350	100
LAND UNDER POSSESSION (AS PER PHYSICAL SURVEY)	47.494	100
AREA UNDER INDUSTRIAL PLOTS	20.222	67.32
AREA UNDER COMMERCIAL	1.182	2.44
AREA UNDER SERVICES	2.545	5.35
AREA UNDER OPEN/GREEN	2.506	5.27
AREA UNDER ROAD	12.038	25.41

TENTATIVE LAY OUT PLAN OF INDUSTRIAL AREA BADLI, TEHSIL-BHINA, DISTRICT AJMER

SCALE: 1 cm = 40.00 mtr. DATE NO: 19/11/2021 DT: 22.11.2021

MISHAL MATHERI
PLANNING ASSISTANT

VIKAS RAJ JAIN
DEPUTY TOWN PLANNER

(GAURAV M. WACHHARE)
Sr. TOWN PLANNER

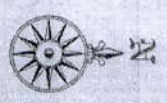

RICO